

2019 NRA Approved Mid-Range Slow Fire Prone High Power Rifle Match

Sponsored By

Burbank Rifle and Revolver Club

The mission of Burbank Rifle and Revolver Club is to promote the shooting sports and foster competition in marksmanship. To foster that end, this series of tournaments is being held to help competitors establish NRA High Power Rifle mid range classifications, to promote good sportsmanship and the practice of rifle marksmanship by the BRRC membership and the shooting community. NRA membership is strongly encouraged but not mandatory.

Tournament dates: January 19th, February 16th, March 16th, April 20th, May 18th, June 15th, July 20th, August 17th, September 21st, October 19th, November 16th, December 30/31st (Annual New Years Eve Club Match).

Match schedule and conditions: 60 shot mid range prone match will be fired in three separate stages. BRRC will intend to transition to an electronic target system but conditions may present itself where it will be necessary to pull targets in the pits under the old system. In the event of such conditions, competitors would be required to perform not simply scoring duties but to operate the targets in the pits.

Matches are geared to 600 yards and up to twenty shooters. At the match director's discretion, a 300 yard stage may be added without notice.

Stage 1 slow fire prone: unlimited sighters with 20 shots for record in a time limit of 30 minutes; fired on the MR-1 target at 600 yards using any rifle and any sights.

Stage 2 slow fire prone: unlimited sighters with 20 shots for record in a time limit of 30 minutes; fired on the MR-1 target at 600 yards using any rifle and any sights.

Stage 3 slow fire prone: unlimited sighters with 20 shots for record in a time limit of 30 minutes; fired on the MR-1 target at 600 yards using any rifle and any sights.

Stage 4 slow fire prone: Aggregate of stages one through three.

Challenge fees: None.

Awards: Prizes will be awarded by either class or rifle type or combination of both at the match director's discretion.

Rules: Current NRA High Power Rifle rules apply. The match is open to any rifle conforming to NRA HP Rifle Rule 3.2 and any sight" conforming to NRA rule 3.7(c).

3.2 Any Rifle - A rifle with no restrictions on sights or accessories, except that it must be safe to competitors and range personnel. Ammunition will be restricted to no larger than .35 caliber. The provisions of Rule 3.16.1 apply to this definition

3.7 Sights (c) Any - Any sight without restriction as to material or construction.

3.16.1 Compensators and Muzzle Brakes -The use of compensators or muzzle brakes is prohibited. (The California legal muzzle device on M1A's is exempted from this restriction).

F Class - You're welcome to participate with F-class rifles and equipment. F-class scores will be used to determine match winner. F-class scores will be submitted to the NRA and will be used for classification separately under the NRA's statistic guidelines. F-Class competitors will shoot on the correct NRA F-Class target for all distances.

Registration/Entry fee: individual entry fee for NRA approved matches is \$20.00 for members, \$30.00 for non (BRRC) members.

Active duty military personnel may be excluded from fees at the match director's discretion.

Entry limit: At match directors discretion, maximum of 20 shooters.

Club New Year's Eve match held on 12/30 and 12/31 are two (2) separate events. Any competitor shooting either day will pay a separate entry fee for each day.

Competition open to: all for approved matches, NRA members for any registered matches.

Entries close: 08:15 am day of match.

Firing starts: 8.45 am

Post entries:

Preregistration/Post entries are required to allow as many shooters to participate as possible. Please contact the match director by email @ brrc@feingersch.com or by phone @ 818-772-7379 to reserve a position. Please be prepared to provide your NRA membership number, address and classification as part of the preregistration process. Preregistration does not guarantee participation in the match. Competitors must arrive prior to entry cut off, pay the match fee and be signed and squadded to assure participation. Late arrivals may be accommodated at the discretion of the match director and pleasure and benefit of the other entrants.

Mail entries to: Entry fees will be due on the day of the event. Do not prepay for these matches as they could be canceled by weather.

Classification of competitors: NRA high power mid range rifle classifications will be used. Be prepared to show proof of your current classification. If you have not yet been issued an NRA mid-range classification, master unclassified will be used.

Safety: Empty chamber indicators will be used. Eye and ear protection is required. Each competitor will receive a copy of the range safety rules and will sign waiver of liability before being allowed to compete. Any disregard for safety may, at the sole discretion of the match officials, result in disqualification from the match and/or expulsion from the range.

Match cancellation: in the event of inclement weather, the match is subject to cancellation This includes rain prior to the day of the match which may make the dirt road passage difficult. If there has been rain in the Castaic area (including the Los Angeles basin) during the week preceding the match, competitors should call to verify that the match will be held. **IF THE ROAD IS WET, DO NOT DRIVE ON THE ROAD!**

Additional Equipment Requirement: As BRRC transitions to an electronic target format, it will be necessary for each competitor to be able to access the electronic targets on an individual basis. Each shooter must be able to access the targeting system wirelessly by laptop, cell phone Android or any other device that is able to access a wireless network. BRRC will not provide the devices and failure to bring such a device would disqualify the shooter from participating in the event.

General information: Competitors and spectators must provide their own drinking water and food. There is a shade structure but providing your own is recommended as an auxiliary measure during the summer months. Their placement shall not interfere with range safety. Lavatory facilities are available. No food or electricity is available. Overnight camping by non-members is available on a limited basis by prior arrangement only. Motel accommodations are available in nearby Castaic. No trash pickup at the range - take out what you bring in.

For additional information concerning the tournament:

visit our web site at <http://BRRC.org>, or contact Mitch Feingersch at (818) 772-7379 (please leave voice message if I'm not available) or by email at midrange@brrc.org or brrc@feingersch.com.

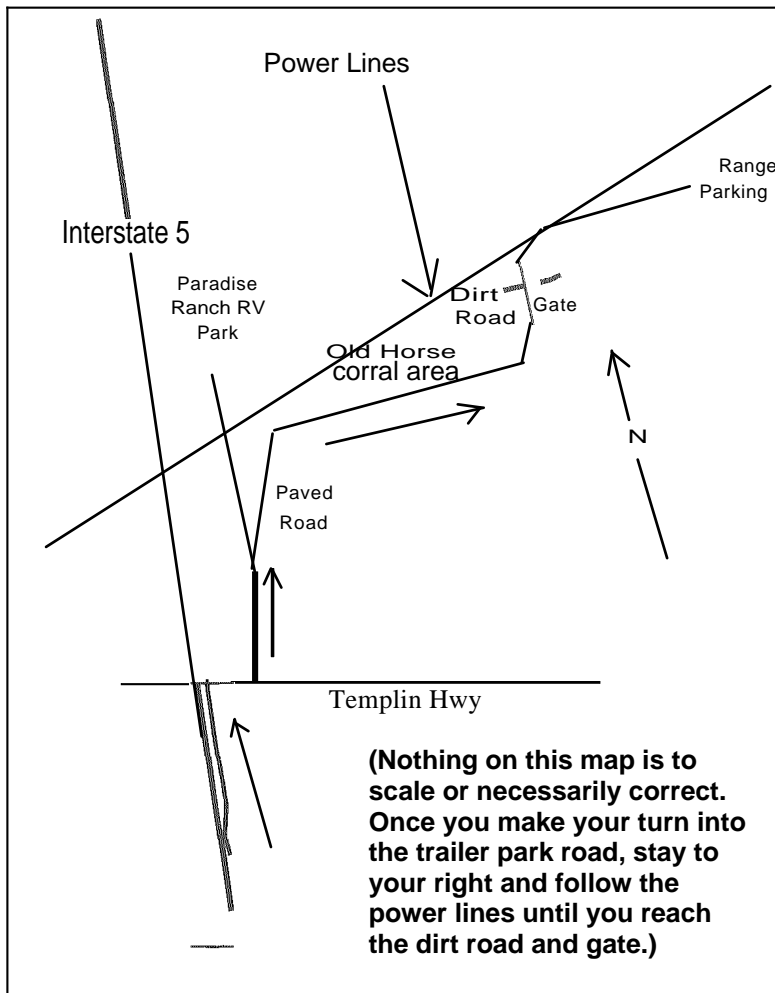

Directions to range: Take Interstate 5 to the Templin Highway off ramp (approx. 5 miles north of Castaic). At the foot of the Templin Hwy off ramp, turn east. Approximately 50 ft east of Interstate 5 turn left (north) onto Paradise Ranch Road. Proceed approximately 200 yd over the rise in the road to where the paved road forks. Go right at the fork. Continue until past the RV park and race track. Near the end of the road, where the paved road turns left (and ends in a driveway shortly thereafter), continue straight ahead leaving the paved surface going onto the narrow dirt road which bends to the left. Follow this road past the entry gate, proceed to the range and park

Club disclaimer:

The club property is located in "wild country". There are critters and varmints that howl & bite in these here woods. We have porta potties on site but no other facilities genteel society might be used to such as running water or snack shops. Using club facilities is at your own risk. You will be asked to sign a waiver of liability every time you enter the club property.